

SITE EXTENT (AS PER APPD. LAYOUT) = / 1215 Sq.M

PUBLIC PURPOSE AREA (1%) = / 18 Sq.M

PP-1 HANDED OVER TO THE LOCAL BODY (0.5%) = 9 Sq.m

PP-2 HANDED OVER TO THE TANGEDCO (0.5%) = 9 Sq.m

NO. OF PLOTS = / 12 Nos.

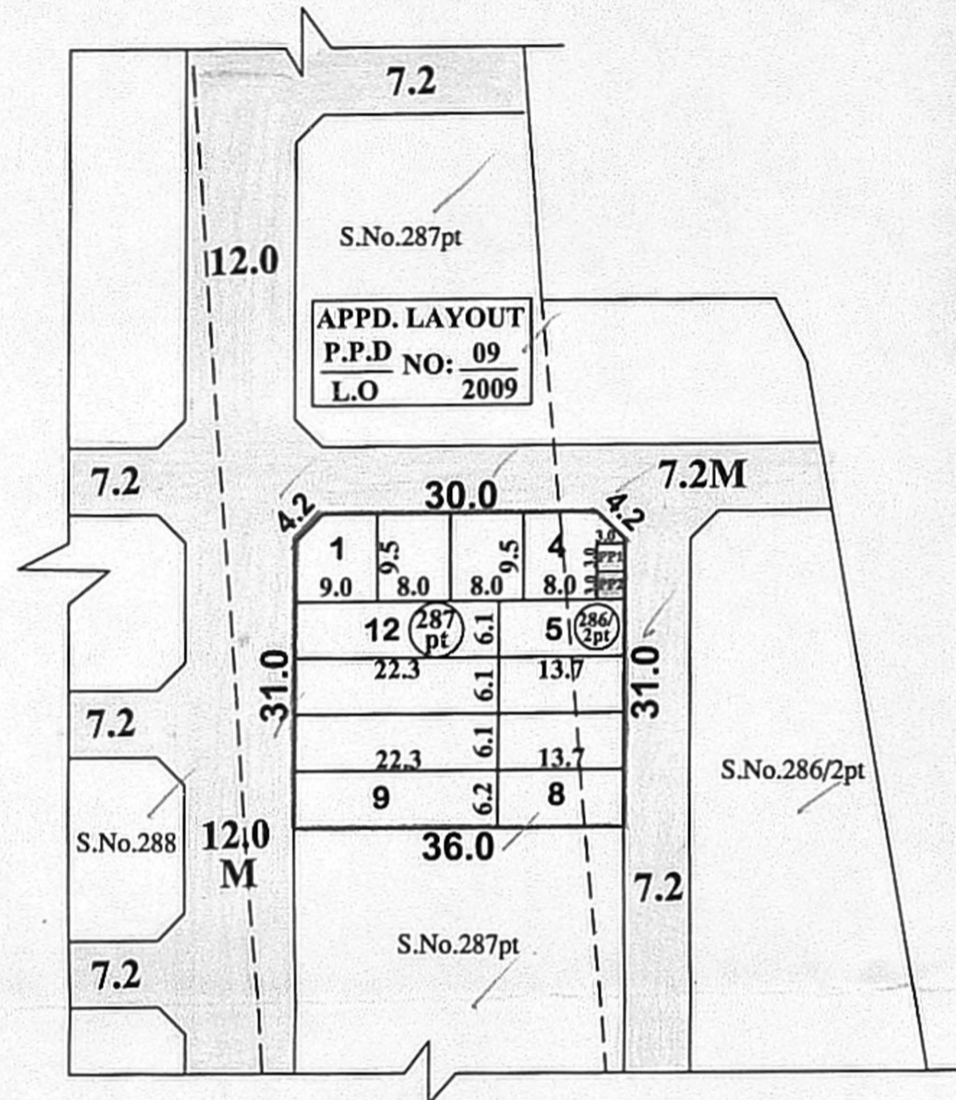

NOTE:

1. MEASUREMENTS ARE INDICATED EXCLUDING SPLAY DIMENSIONS

2. PUBLIC PURPOSE AREA-1] WERE HANDED OVER TO THE LOCAL BODY VIDE GIFT DEED
 PUBLIC PURPOSE AREA-2] DOC. NO: 2812 / 2021, DATED: 11/02/2021 @ SRO, KUNRATHUR
 (RESERVED FOR TANGEDCO)

CONDITION

(I) TNCDBR-2019 RULE NO: 47 (8) IN G.O.(Ms) No.18, MAWS DEPARTMENT DATED 04.02.2019 & AMENDMENTS APPROVED IN G.O.Ms.NO.16, MAWS (MAI) DEPARTMENT DATED 31.01.2020 AND PUBLISHED IN TNGG ISSUE No.41, DATED:31.01.2020:

ONE PERCENT OF LAYOUT AREA EXCLUDING ROAD, ADDITIONALLY, SHALL BE RESERVED FOR "PUBLIC PURPOSE". WITHIN THE ABOVE CEILING 0.5% OF AREA SHALL BE TRANSFERRED TO THE LOCAL BODY AND 0.5% OF AREA SHALL BE TRANSFERRED TO THE TANGEDCO OR TO THE LOCAL BODY FREE OF COST THROUGH A REGISTERED GIFT DEED BEFORE THE ACTUAL SANCTION OF THE LAYOUT.

(II) TNCDBR-2019, RULE NO:47 (11)

THE COST OF LAYING IMPROVEMENTS TO THE SYSTEMS IN RESPECT OF ROAD, WATER SUPPLY, SEWERAGE, DRAINAGE OR ELECTRIC POWER SUPPLY THAT MAY BE REQUIRED AS ASSESSED BY THE CONCERNED AUTHORITY, NAMELY, THE LOCAL BODY AND TAMIL NADU ELECTRICITY BOARD, SHALL BE BORNE BY THE APPLICANT.

⊙ NECESSARY SPACE FOR BUILDING LINE TO BE LEFT AS PER THE RULE IN FORCE WHILE TAKING UP DEVELOPMENT IN EVERY PLOT.

LEGEND:

- ▬ SITE BOUNDARY
- ▬ EXISTING ROAD
- ▬ PUBLIC PURPOSE-1 GIFTED TO LOCAL BODY
- ▬ PUBLIC PURPOSE-2 GIFTED TO TANGEDCO

CONDITIONS:

THE LAYOUT APPROVED IS VALID SUBJECT TO OBTAINING SANCTION FROM THE LOCAL BODY CONCERNED.

P.P.D NO : 29
 L.O 2021

APPROVED

VIDE LETTER NO : L1 / 12506 / 2020
 DATE : 26 / 02 / 2021

FOR CHIEF PLANNER (LAYOUT)
 CHENNAI METROPOLITAN
 DEVELOPMENT AUTHORITY

PREPARED BY P.A-IV
 26/02/2021

P.A.I
 26/02/2021

A.P.
 26/02/2021

KUNDRATHUR PANCHAYAT UNION

SKETCH SHOWING THE RE-DESIGNATION OF SCHOOL SITE LYING IN CMDA APPROVED LAYOUT VIDE PPD/LO.No:9/2009 INTO HOUSE SITES IN S.No: 286/2pt & 287pt OF MALAYAMBAKKAM VILLAGE.

SCALE : 1:800 (ALL MEASUREMENTS ARE IN METRE)

